

# 941 STURDIES BAY RD.

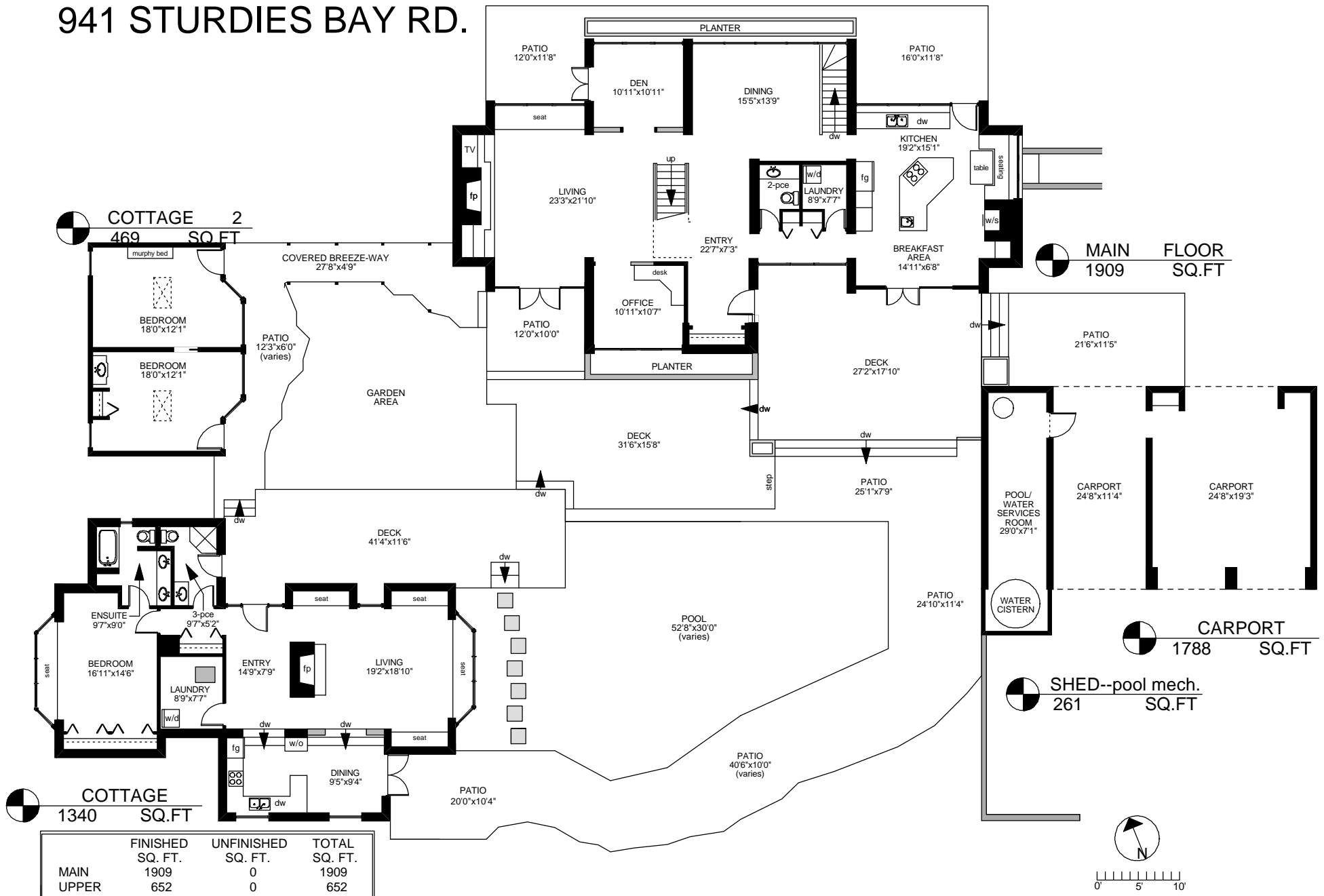

	FINISHED SQ. FT.	UNFINISHED SQ. FT.	TOTAL SQ. FT.
MAIN	1909	0	1909
UPPER	652	0	652
LOWER	0	1022	1022
<b>TOTAL</b>	<b>2561</b>	<b>1022</b>	<b>3583</b>
CARPORT	0	792	792
COTTAGE	1340	0	1340
COTTAGE 2	469	0	469
PATIOS	0	1692	1692
DECKS	0	1623	1623
SHED	0	261	261
G-HOUSE	0	89	89

PREPARED FOR THE EXCLUSIVE USE OF  
 PETER NASH OF MACDONALD REALTY VICTORIA  
[www.peternash.com](http://www.peternash.com)

MEASURED ON: 10/25/10  
 DRAWING FILE: 08503

**Tafe Measure** VICTORIA, B.C.  
 Ph. 883.8894  
[www.tafemeasure.com](http://www.tafemeasure.com)